



# City of Woburn

PURCHASING DEPARTMENT  
City Hall  
10 Common Street  
Woburn, MA 01801

Scott D. Galvin, Mayor  
Orazio P. DeLuca, MCPPO

Tel.: 781-897-5950  
Fax: 781-897-5954

To: Potential Contractors

From: Orazio DeLuca, Chief Procurement Officer

Date: 3/9/2018

Re: Addendum #1 to RFP 18-09 Farmstand Roof Replacement  
*Due date Change, Specification change(s)*

---

The City is issuing Addendum #1 to IFB 18-09 Farmstand Roof Replacement Project to:  
**Change the Bid Due Date AND address changes in Specifications.**

1. **The Bid Due Date will be changed to:**

**THURSDAY, MARCH 15, 2018 @ 1:00 PM**

2. **PLEASE SEE THE ATTACHED FOR SPECIFICATION CHANGES TO THIS PROJECT**

**Be sure to acknowledge the addendum in your bid response or it will be deemed non responsive**

Regards,

*Orazio DeLuca*

Orazio DeLuca, MCPPO

ADDENDUM ONE

to

PROJECT MANUAL

for

HURLD-WYMAN SCHOOL SITE  
FARMSTAND ROOF REPLACEMENT  
Woburn, Massachusetts

DATE: 09 March 2018

ARCHITECT: DiNISCO DESIGN, INC.  
99 Chauncy Street, Suite 901  
Boston, MA 02111

This Addendum modifies, amends and supplements designated parts of the CONTRACT DOCUMENTS for the project identified as **HURLD-WYMAN SCHOOL SITE FARMSTAND ROOF REPLACEMENT**, WOBURN, MASSACHUSETTS, dated **21 FEBRUARY 2018** and is hereby made a part thereof by reference, and shall be as binding as though inserted in its entirety in the locations designated hereunder. It shall be the responsibility of the General Contractor to notify all subcontractors and suppliers he proposes to use for the various parts of the work of any changes or modifications contained in this Addendum. No claim for additional compensation due to lack of knowledge of the contents of this Addendum will be considered.

**A. CHANGES TO THE PROJECT MANUAL**

1. SECTION 015000-TEMPORARY FACILITIES AND CONTROLS

- a. Page 015000-4, Article 1.16 GENERAL CONTRACTOR'S OFFICE, delete Paragraph A in its entirety and substitute "NOT USED".
- b. Page 015000-5, Article 1.18 TEMPORARY TELEPHONE, delete Paragraph A, including Subparagraphs A.1 and A.2 in their entirety. Substitute the following new Paragraph A:

"A. Provide superintendent with cellular telephone. Superintendent shall carry telephone or radio at all times while on site. Maintain service until Final Completion."

2. SECTION 073113-ASHPALT SHINGLE ROOFING

- a. Page 073113-1, Article 1.02 SCOPE OF WORK, revise subparagraph A.1 to read as follows:

"1. Remove and dispose of existing asphalt roofing system, including nails and underlayment felts; existing rotted sheathing and trim wood; and any other elements required to be removed to perform the work in this contract."

**B. CHANGES TO THE CONTRACT DRAWINGS**

1. DRAWING 3.5.01 ROOF PLANS, ELEVATIONS & GENERAL NOTES

- a. At General Notes, revise the first bullet point under 1 – Existing Conditions, to read as follows:

*"Existing plan dimensions shown on 5/3.5.01 are approximate. The Contractor shall verify all existing dimensions and conditions prior to commencing work. The Contractor is responsible for notifying the Architect of any existing conditions that deviate from the Drawings and which will impact the Work."*

2. DRAWING 3.5.02 RE-ROOFING DETAILS

- a. Drawing 3.5.02 reissued with revisions to Detail 8 - Kitchen Exhaust Fan Curb - Elevation; Detail 9 - Kitchen Exhaust Fan Curb Section Detail; and new Detail 8A - Up Slope Curb Elevation, inserted.

END OF ADDENDUM NO. 1

# HURLD-WYMAN SCHOOL SITE FARMSTAND ROOF REPLACEMENT

Woburn, MA

**DINISCO DESIGN**  
architects + planners

99 Chauncy Street, Suite 901  
Boston, MA 02111  
(617) 426-2858  
FAX (617) 426-1457

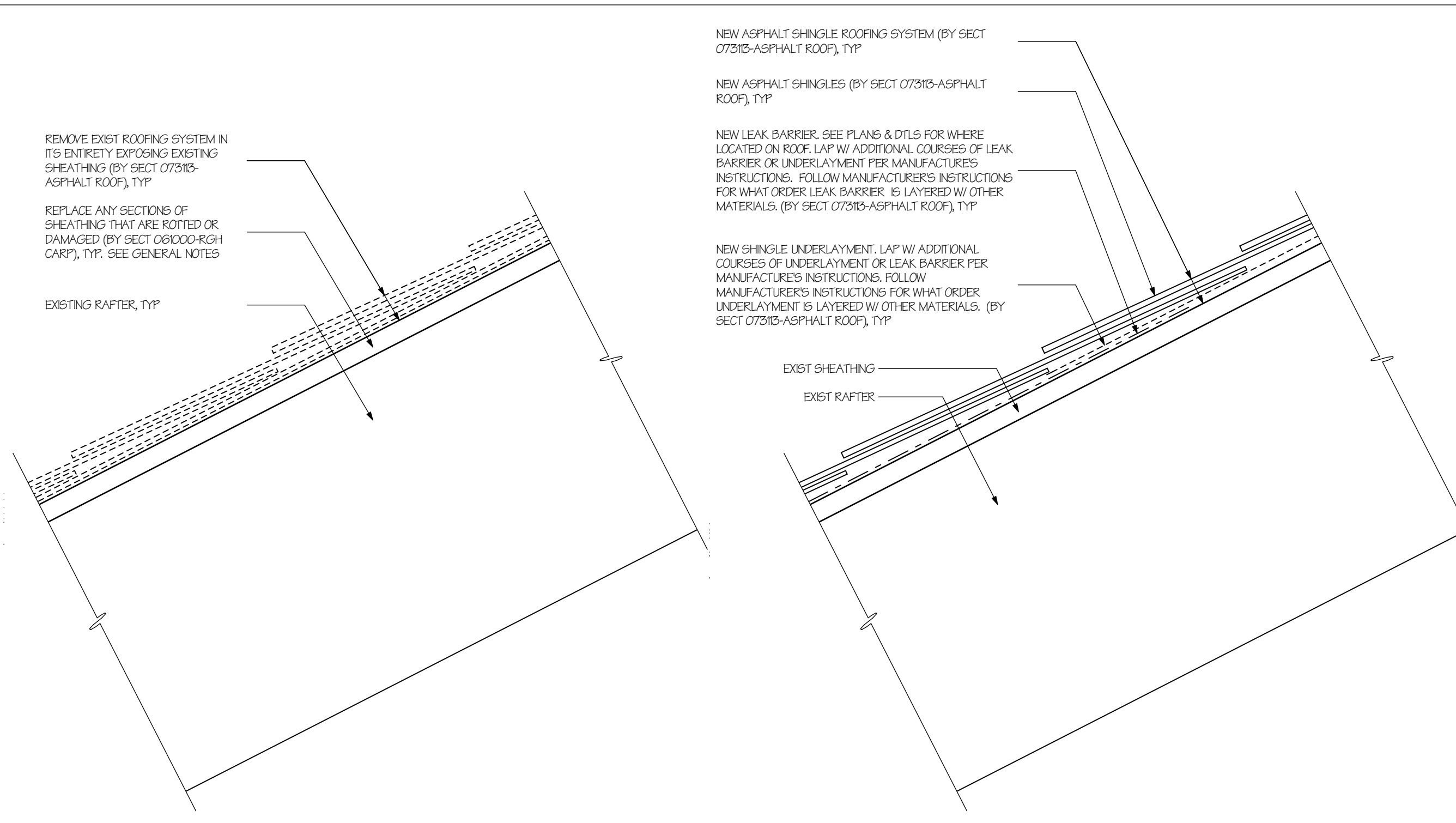

**1**  
3.5.01  
**Existing Roofing Removal**  
SCALE: 3" = 1'-0"

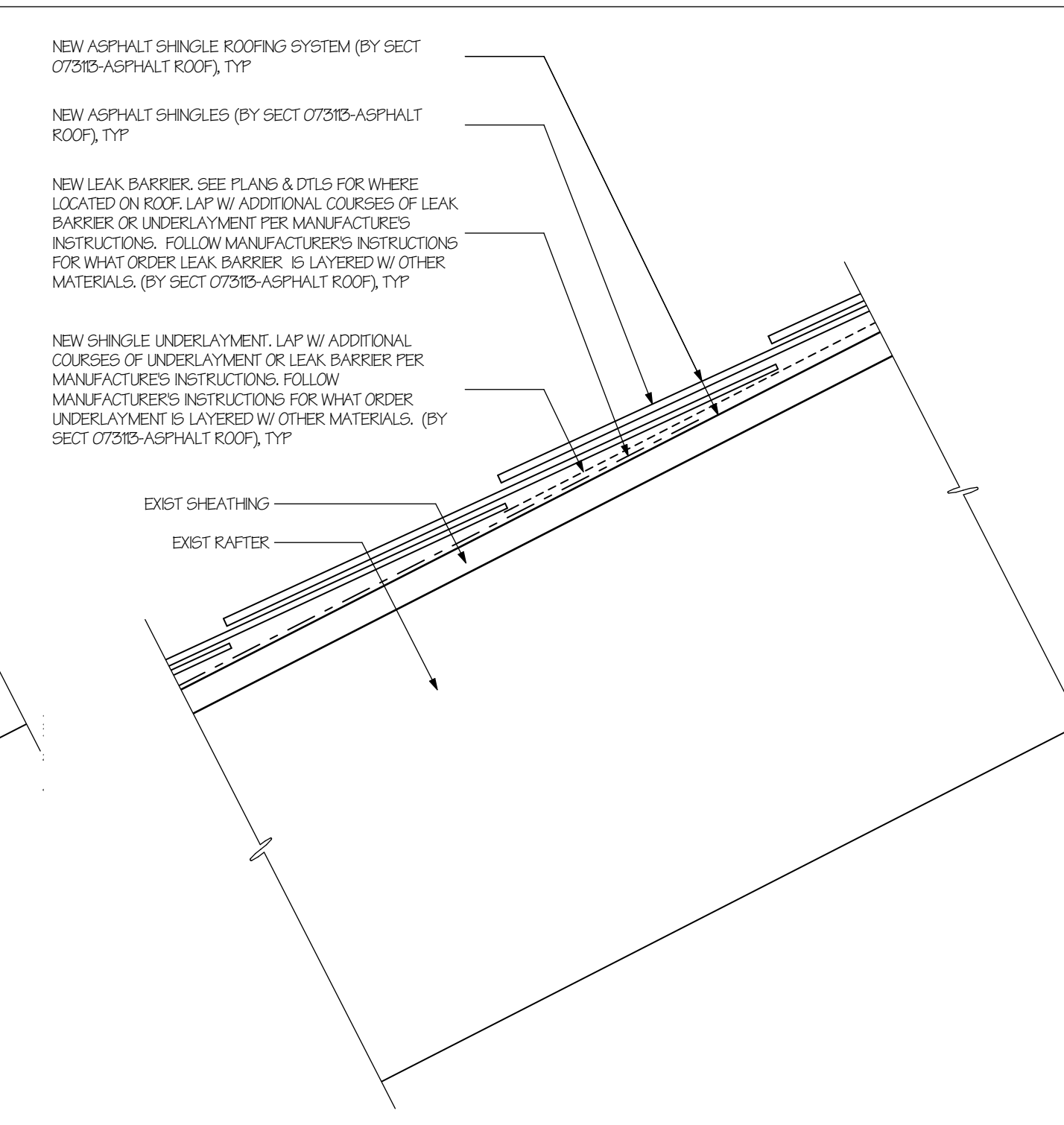

**2**  
3.5.01  
**Re-Roofing**  
SCALE: 3" = 1'-0"

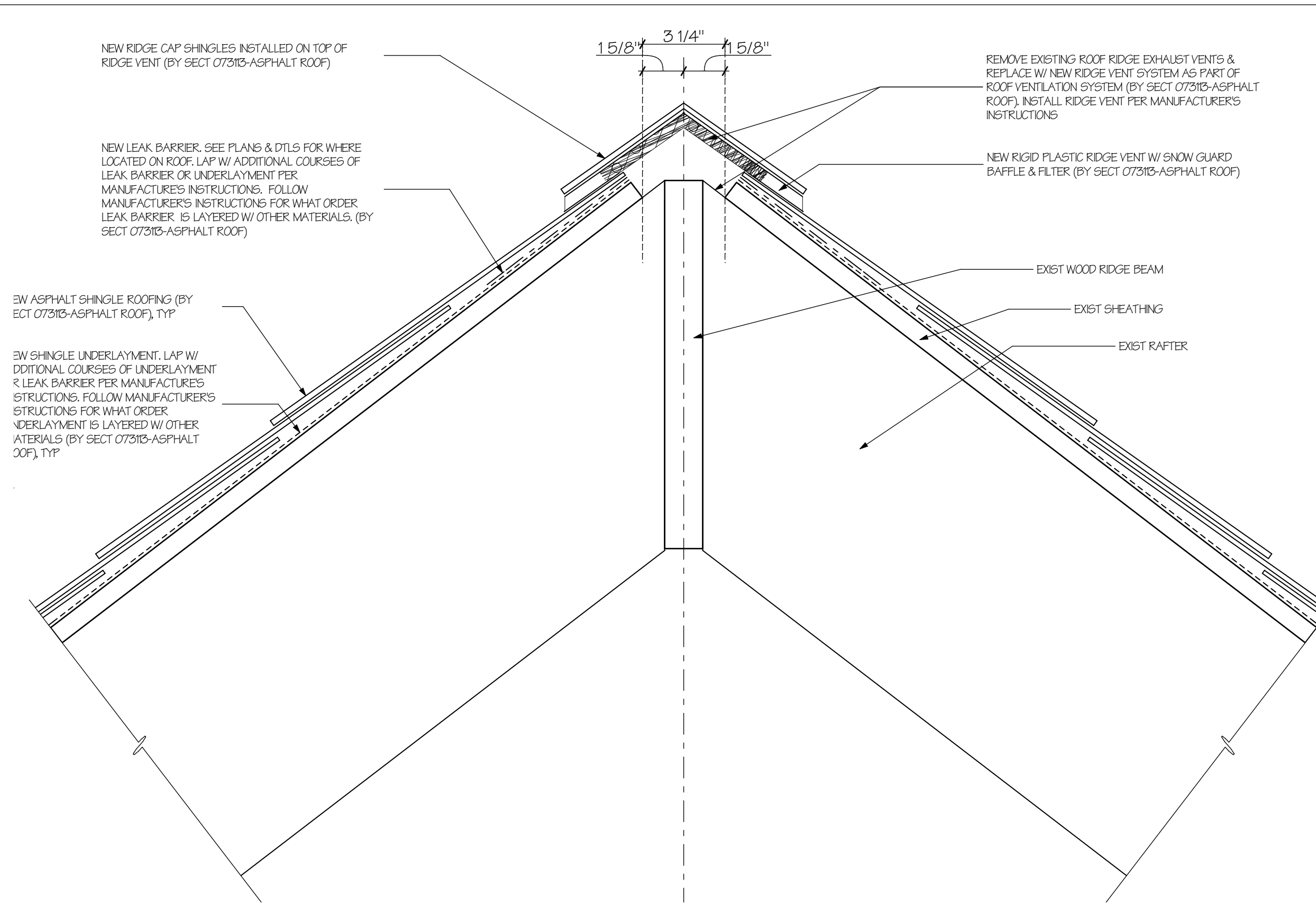

**5**  
3.5.01  
**Ridge Detail**  
SCALE: 3" = 1'-0"

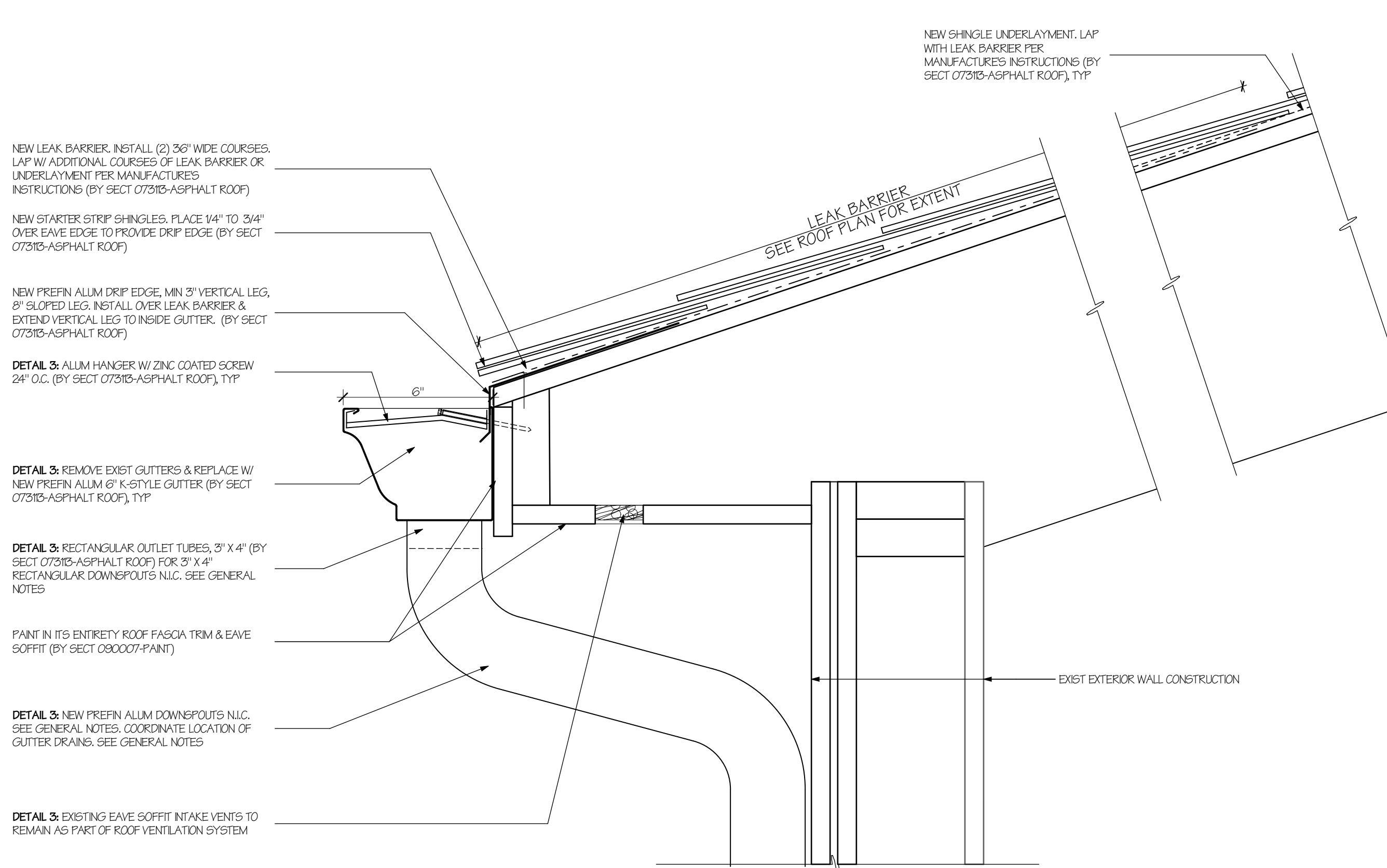

**3**  
3.5.01  
**Roof Eave Edge Detail**  
SCALE: 3" = 1'-0"

**3A**  
3.5.01  
**Roof Eave Edge Detail @ Cupola, Similar**

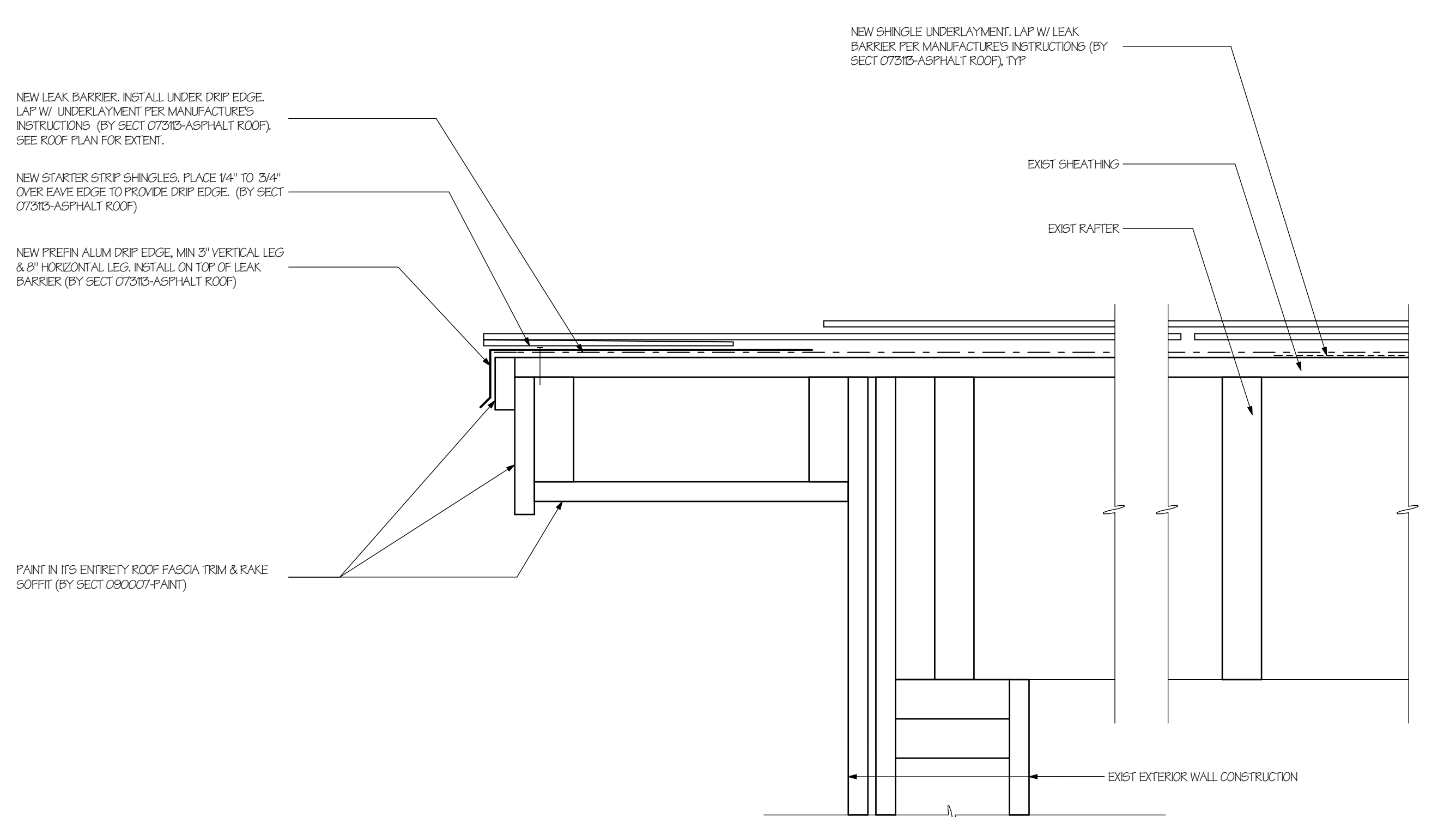

**4**  
3.5.01  
**Roof Rake Edge Detail**  
SCALE: 3" = 1'-0"

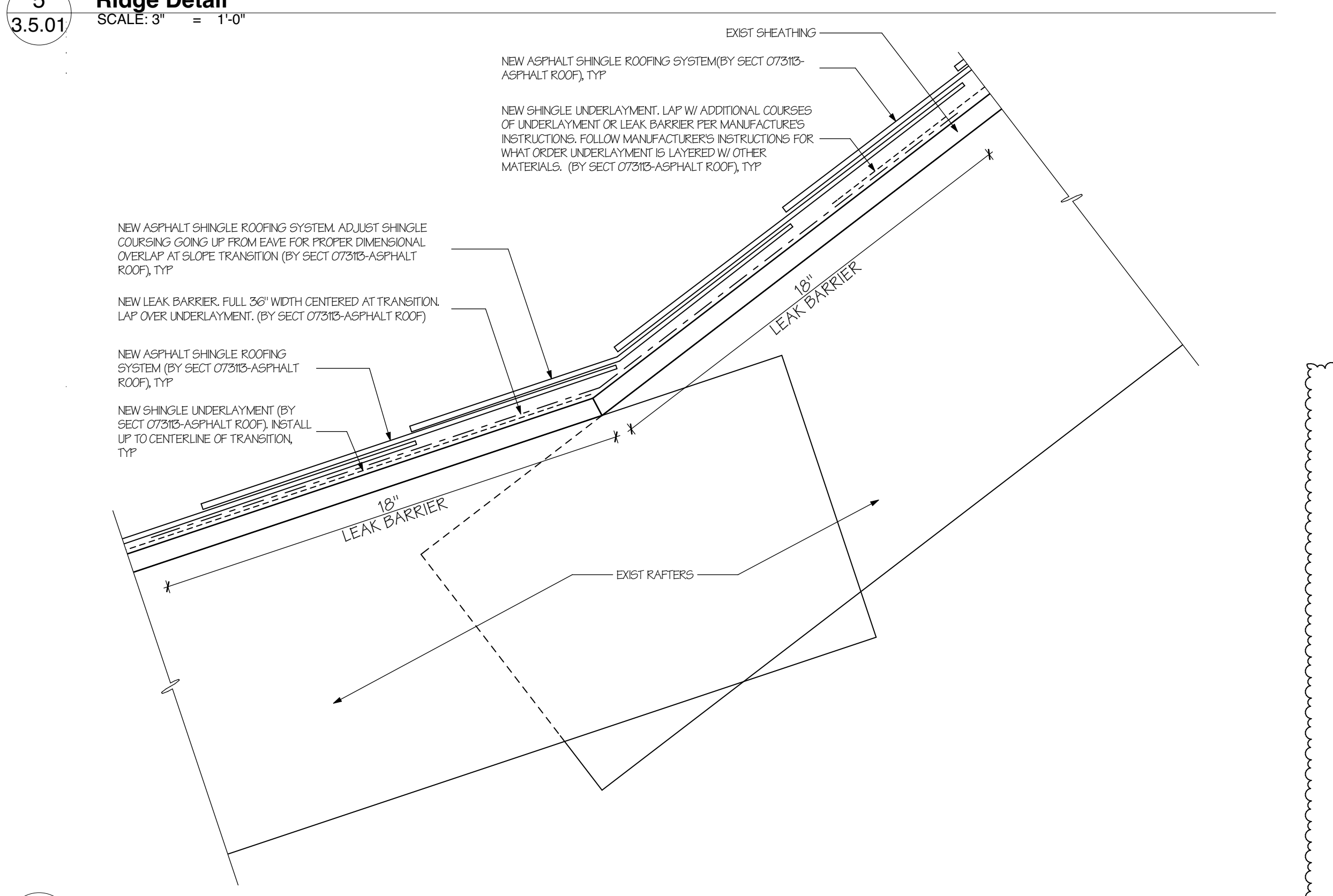

**6**  
3.5.01  
**Slope Transition Detail**  
SCALE: 3" = 1'-0"

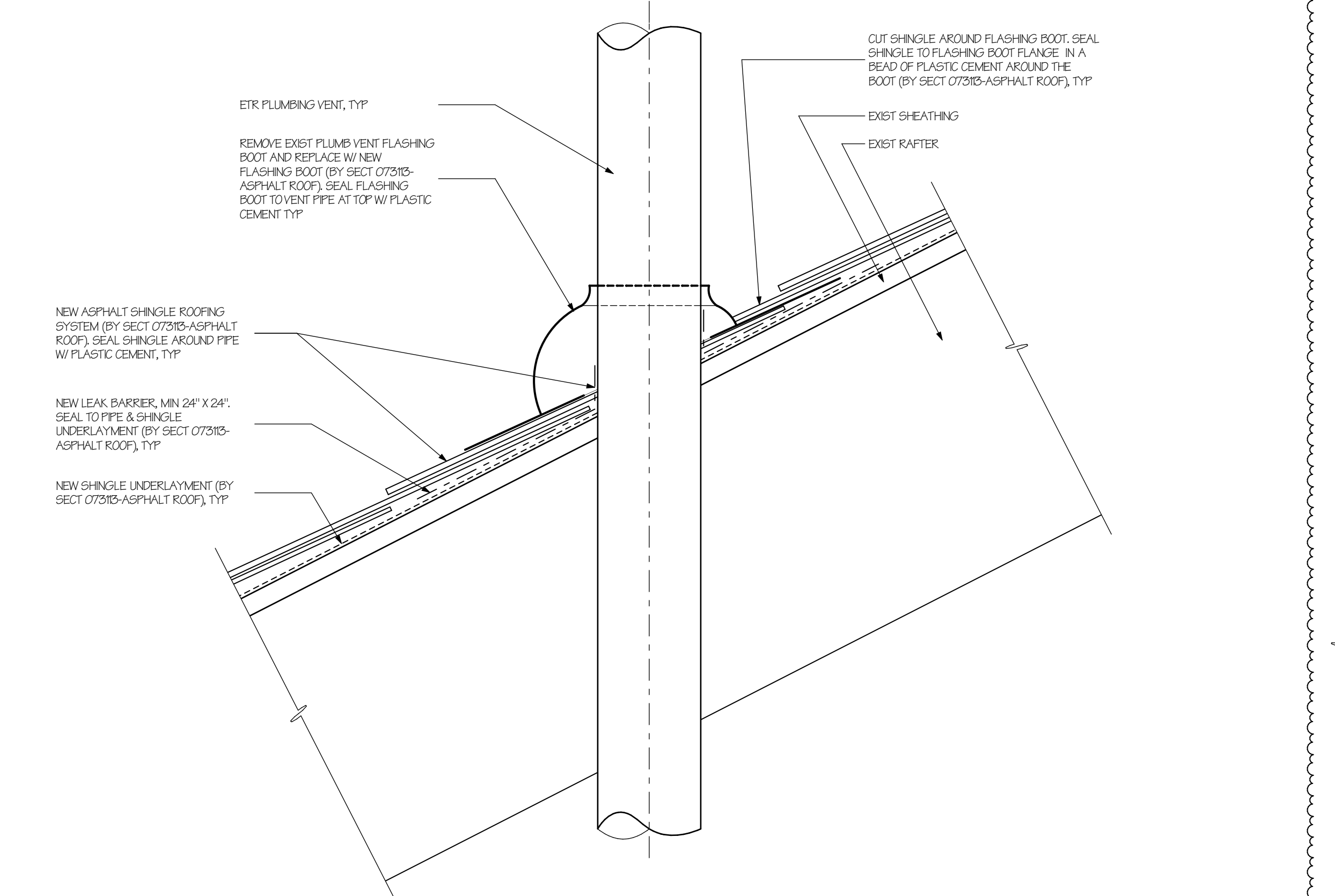

**7**  
3.5.01  
**Existing Vent Pipe Flashing Detail**  
SCALE: 3" = 1'-0"

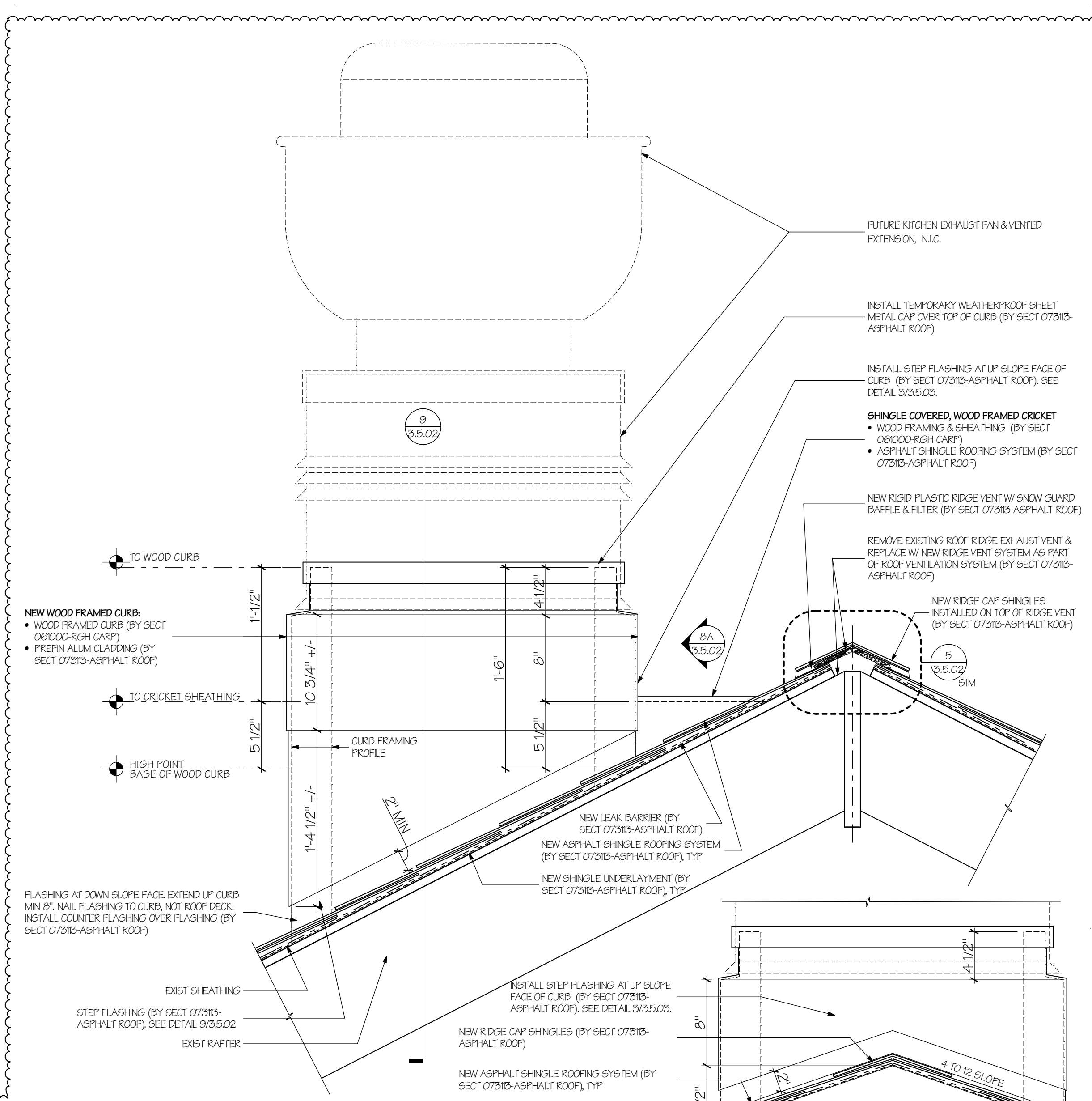

**8**  
3.5.01  
**Kitchen Exhaust Fan Curb - Elevation**  
SCALE: 1 1/2" = 1'-0"

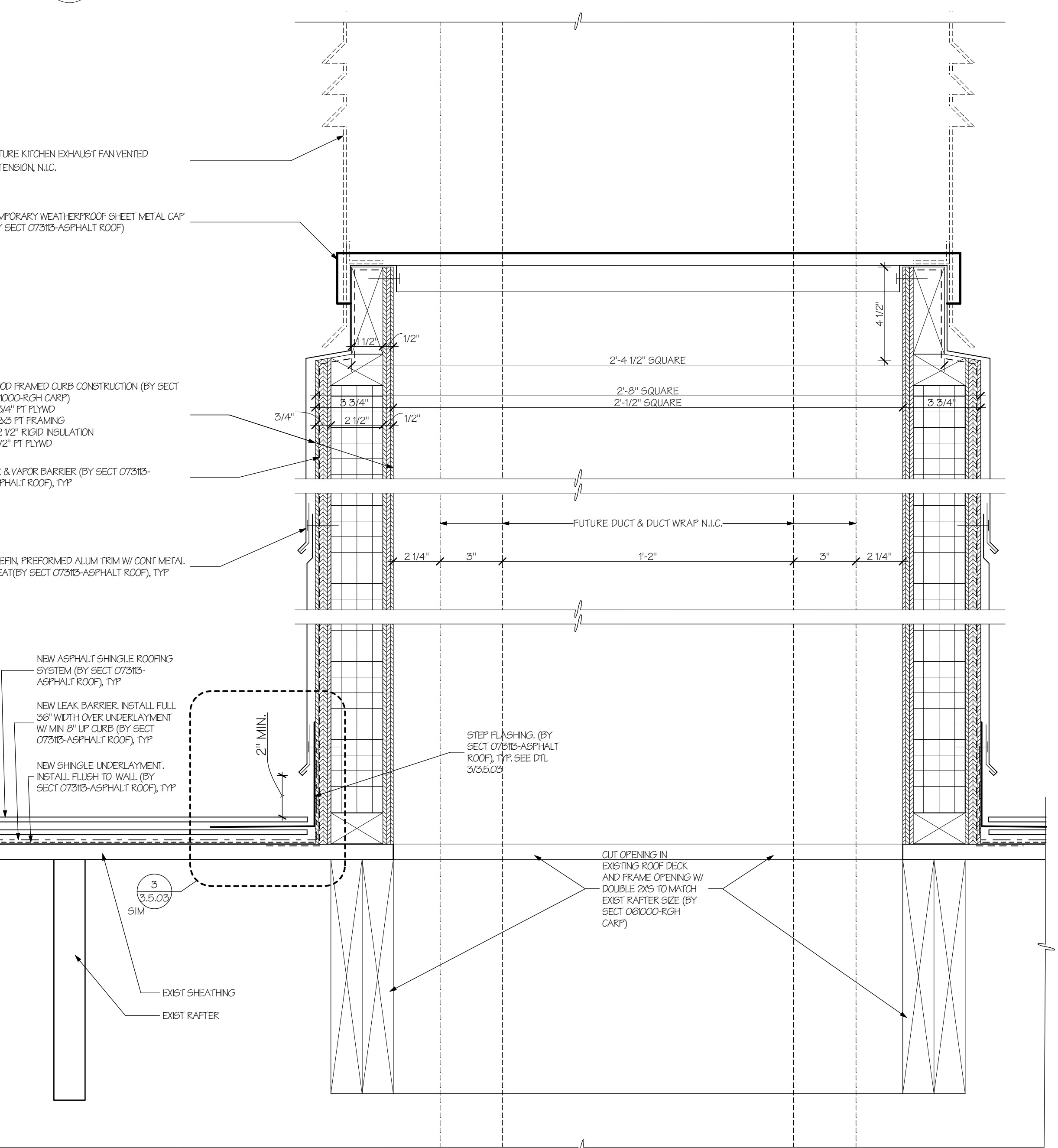

**9**  
3.5.01  
**Kitchen Exhaust Fan Curb Section Detail**  
SCALE: 3" = 1'-0"

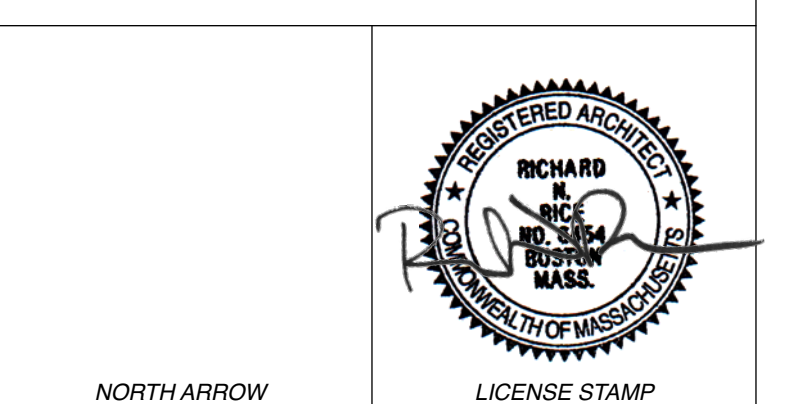

DATE: 01 MARCH 2018  
DRAWN BY: JAO  
SCALE: 0 4" 8"  
REVISIONS:  
Number Date Description  
3 03/09/18 Addendum 1

PROGRESS CONSTRUCTION DOCUMENTS  
**Re-Roofing Details**

**3.5.02**